

Performing A Leak Down Test with the KM601

Step 1

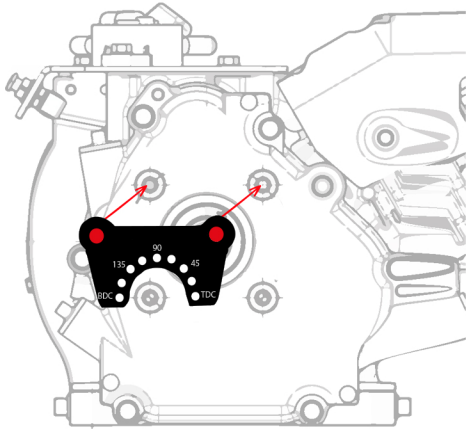

Install plate to engine cover with bolts from the chain guard.

FINGER TIGHTEN ONLY!

Step 2

Slide handle onto crankshaft

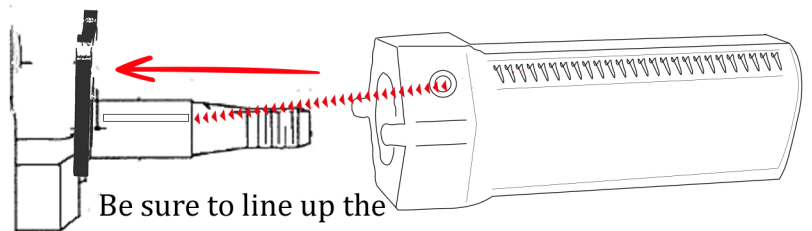

Be sure to line up the set screw with the crankshaft keyway

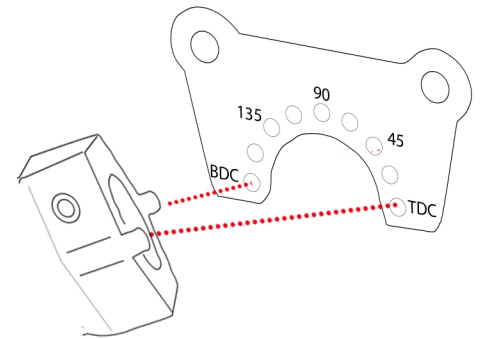

Slide the 2 alignment pins on the handle

into the BDC and TDC holes

Step 3

Tighten the 2 plate bolts

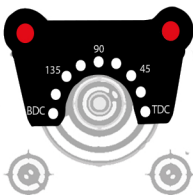

Tighten the set screw on the handle so it remains tight in the crankshaft keyway

You are now setup to perform your 1st leak down test in the TDC (Top Dead Center) position.

For additional tests rotate handle to align pin in the other positions in the plate. (you will only use 1 pin in the other positions) In total, you can check leak down at TDC, BDC and 7 positions between.

This tool is also useful for rotating the crankshaft when setting the valve lash or checking valve lift.

